

Vanilla Pop Stage Configuration – 4'x8' Sections

Most portable stages come in 4'x 8' sections.
Below is our preferred setup.

This is our ideal set up

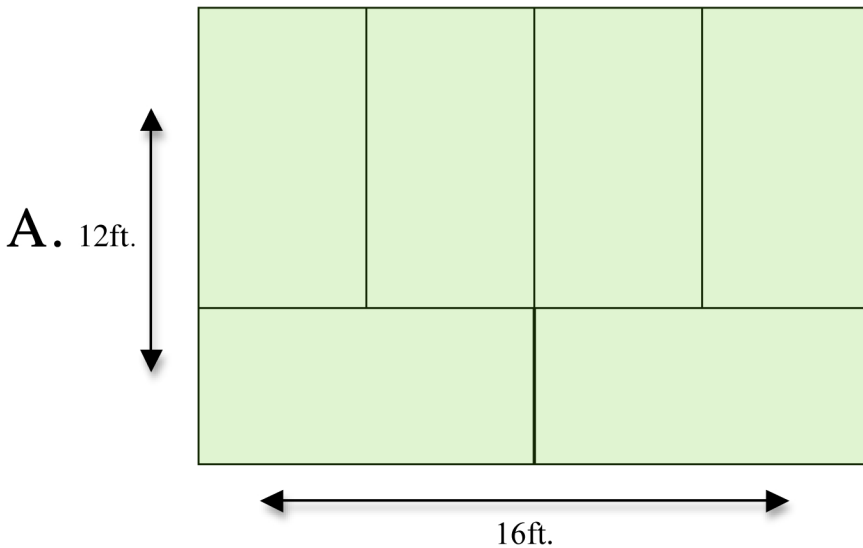

If the above setup is not possible, this smaller configuration will work.

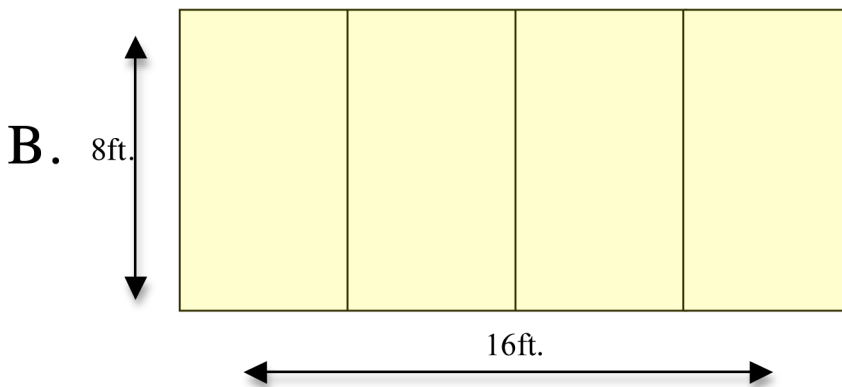

This is our minimum stage size requirement

Extremely tight for us- for venues with very limited space only.

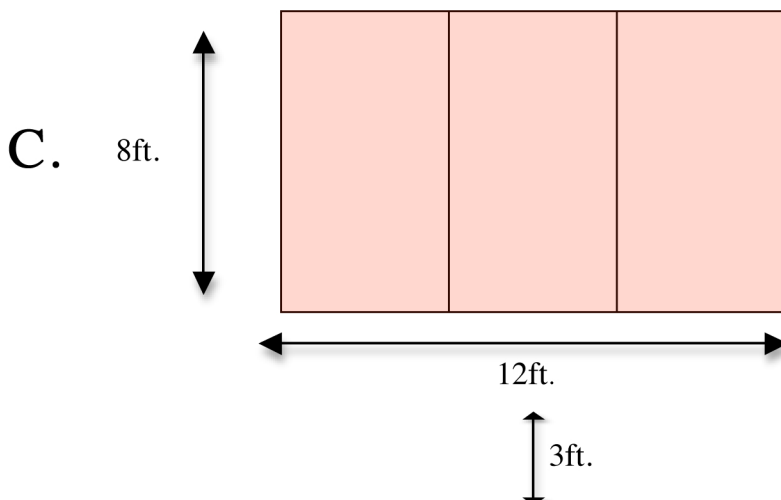

Please allow 3 ft. of space between
front of stage and dance floor
in order to accomodate speakers.

DANCE FLOOR